

Overview

HPE ProLiant e910t Server Blade

Are you wanting to move software applications and compute closer to the user? Do you need to reduce moving the vast amounts of data to a centralized data center?

The ProLiant e910 Server Blade allows you to deploy edge compute close to where the data is being generated, conserving uplink bandwidth, connectivity cost, lowering security and corruption risk, improving compliance to data protection laws, and greatly reducing time to actionable insight.

It features a rugged, compact design that is certified for extended thermal environments of 0° to 55° Celsius and is installed in the Size, Weight and Power (SWaP) optimized Edgeline EL8000t Converged Edge System. The ProLiant e910t server blade architecture is based on Intel® Xeon® SP processors to give you increased compute power and speed. The modular design of the HPE ProLiant e910t Server Blade provides a broad range of configuration choices in networking, storage and I/O for optimizing your unique edge workloads.

Enterprise Data Center Compute Capacities Now Can Be Deployed at The Edge

The ProLiant e910t Server Blade supports industry standard technology leveraging the Intel® Xeon® Scalable Processor Family, and can be configured with fast high-capacity (TB) storage to support enterprise-tier edge workloads. High performance I/O including accelerators, allow it to support the same demanding software applications run in a datacenter or cloud, but now at the edge. The best of HPE's industry standard technologies can now benefit customers at the edge for use cases in telecommunications, defense, law enforcement, disaster response etc.

Seamless Remote Manageability for Deep Edge Environments

The ProLiant e910t Server Blade includes Integrated Lights-Out technology (iLO5) that provides server management capabilities and cutting edge security technologies such as Silicon Root of Trust so you can securely configure, monitor, and update your HPE servers seamlessly and from anywhere.

HPE iLO5 simplifies server setup, provides access to server health information, enables server management at scale, and improves server power and thermal control, as well as basic remote administration. The iLO5 Advanced feature provided with each ProLiant e910t blade allows automation of common tasks during each step of the server lifecycle and improved detection and enforcement of security to, increasing ROI and decreasing TCO.

Modular Configurations for Workload Optimization

The Edgeline EL8000t system provides 2 independent 2U slots for configuring ProLiant e910t 2U Server Blades.

Standard Features

Server Blade Components

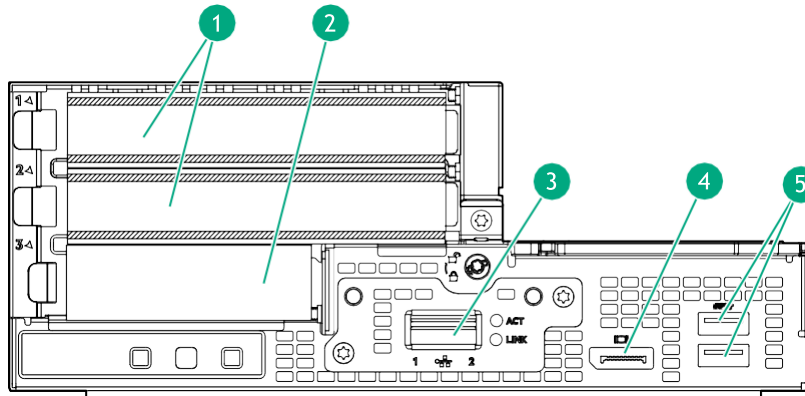

Item Description

- 1. Two (2) Full Height, Full Length PCIe Slots
- 2. One (1) Half Height, Half Length PCIe Slot
- 3. Network Connector (4 port QSFP+)

Item Description

- 4. One (1) Display Port
- 5. Two (2) USB 3.0 Ports

Server Blade LEDs

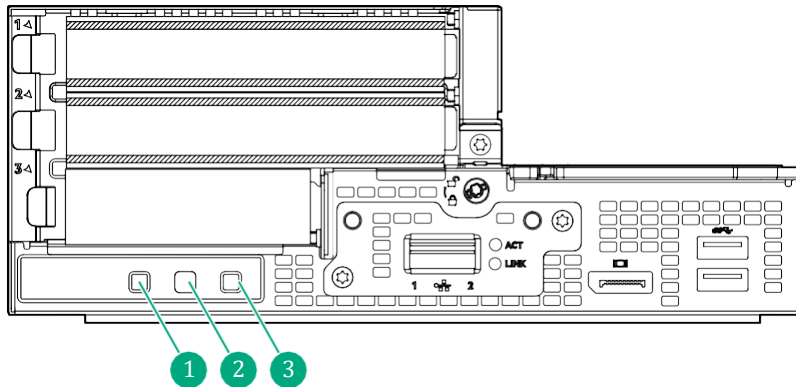

1. UID LED

Notes:

- Blue = Blade id is enabled
- Flashing Blue = Blade firmware update is in progress and/or Integrated Remote Console (IRC) is in use
- Off = Blade id is not enabled

2. Health LED

Notes:

- Green = Normal operation
- Flashing amber = Degraded condition
- Flashing red = Critical condition
- Off = No power

3. Power LED

Notes:

- Green = Normal operation
- Amber = Standby operation
- Off = No power



Standard Features

System Board Components

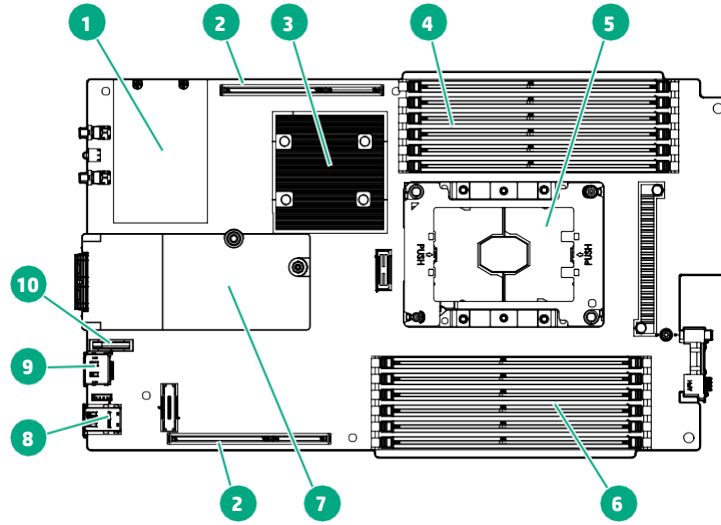

- | | |
|----------------------------------------------|---------------------------|
| 1. M.2 SSD Slots | 6. DIMM slots |
| 2. Left (Top) and Right (Bottom) Riser Slots | 7. Network Riser Option |
| 3. Heatsink (chipset) | 8. USB Connectors |
| 4. DIMM slots | 9. Display Port Connector |
| 5. Processor Socket | 10. System Battery |
-



Standard Features

Processor

2nd Generation Intel® Xeon® Scalable Processor Family							
Intel® Xeon® SP	Frequency	Cores	L3 Cache	Power	UPI	DDR4 MHz	Max Memory
Platinum 8280M Processor	2.7Ghz	28	38.5	205W	3 UPI links	2933MT/s	2TB
Gold 6254 Processor	3.1Ghz	18	24.75	200W	3 UPI links	2933MT/s	1TB
Gold 6244 Processor	3.6Ghz	8	24.75	150W	3 UPI Links	2933MT/s	1TB
Gold 6230N Processor	2.3Ghz	20	27.5	125W	3 UPI links	2933MT/s	1TB
Gold 6212U Processor	2.4GHz	24	35.75	165W	n/a	2933MT/s	1TB
Silver 4210 Processor	2.2Ghz	10	13.75	85W	2 UPI links	2400MT/s	1TB

Notes:

- For more information regarding Intel® Xeon® SP, please see the following URL:
<https://www.intel.com/content/www/us/en/products/processors/xeon/scalable.html>
- The ProLiant e910t 2U server is only available as a single-socket system, so UPI capability is not used
- At least an Intel Xeon 8280M processor is required to use the full memory capacity of the ProLiant e910
- The UPI functionality is not available on the Intel Xeon 6212U Processor, as it is single-socket optimized.

Chipset

Intel® C624 Chipset

Notes: For more information regarding chipset, please see the following URL:

<https://www.intel.com/content/www/us/en/products/chipsets/server-chipsets/c624.html>

Graphics

Integrated Video Standard

- Video modes up to 1920 x 1200@60Hz (32 bpp)
- 16MB Video Memory

HPE iLO 5 system management memory

- 32 MB Flash
- 4 Gbit DDR 3 with ECC protection

On System Management Chipset

HPE iLO 5 ASIC

Notes: Read and learn more in the [iLO QuickSpecs](#)



Standard Features

Memory

Type	HPE Edgeline DDR4 Registered (RDIMM), Load Reduced (LRDIMM)	
Supported DIMMs	DDR4-2933	
DIMM Slots Available	12	12 DIMM slots per processor, 6 channels per processor, 2 DIMMs per channel
Maximum Capacity (LRDIMM)	1.5 TB	12 x 128GB LRDIMM
Maximum Capacity (LRDIMM)	768 GB	6 x 128GB LRDIMM
Maximum Capacity (LRDIMM)	768 GB	12 x 64GB LRDIMM
Maximum Capacity (RDIMM)	384GB	12 x 32GB RDIMM

Notes:

- Rules under “Memory” section must be followed for Configuring and Mixing of DIMMs.
- Usable system memory is constrained by the configured processor type

Memory Protection

For details on the HPE Server Memory Options RAS feature, visit:

<http://www.hpe.com/docs/memory-ras-feature>.

Network

- Intel® X722 Quad-port 10GbE (in embedded PCH)
Accessed through the following optional network riser module options:
 - P17295-B21: HPE ProLiant e910 2p 10GbE RJ45 Network Riser
 - P17296-B21: HPE ProLiant e910 2p 10GbE SFP+ Network Riser
 - P12392-B21: HPE ProLiant e910 4x10GbE QSFP+ Module
- Intel® I210 1GbE
Accessed through management network port on EL8000t chassis controller module

SATA and PCIe controllers are Integrated in the Intel® Chipset

SSD Slot #	Physical Location	Technology	Bus Width	Connector Width	Form Factor	Supported Sizes
1	System Board	SATA-3, PCIe-3	x1, x2	x1, x2	M.2 2242/2280	120GB 240GB 256GB 512GB 1TB 2.048TB
2	System Board	SATA-3, PCIe-3	x1, x2	x1, x2	M.2 2242/2280	120GB 240GB 256GB 512GB 1TB 2.048TB
3	Expansion Option	PCIe-3, NVMe	x4	x4	M.2 2280/22110	256GB 512GB 1TB 2.048TB 960GB 1.92TB 3.84TB



Standard Features

Maximum Internal Storage

- M.2 2242 SATA solid state device
480GB
2x 240 GB
- M.2 2280 NVMe solid state devices
11.5TB
6x 1.92TB
- M.2 22110 NVMe solid state device
15.2TB
4x 3.8TB

Power Supply

Refer to the Edgeline EL8000t Quick

Specs <https://h20195.www2.hpe.com/v2/getdocument.aspx?docname=a00073755enw>

System Fans

Refer to the Edgeline EL8000t Quick Specs <https://h20195.www2.hpe.com/v2/getdocument.aspx?docname=a00073755enw>

Interfaces

- Server Blade Power LED/button
- Server Blade UID LED/button

Operating Systems and Virtualization Software

Support for ProLiant Servers

RedHat Enterprise Linux (RHEL) v7.6 and v8.0

Windows Server 2016 and 2019

Notes:

- Only 64-bit versions of these operating systems are supported
- For more information on the Hewlett Packard Enterprise Certified and Supported ProLiant Servers for OS and Virtualization Software and latest listing of software drivers available for your server, please visit our OS Support Site at <http://www.hpe.com/info/ossupport> and our driver download page which can be found from the HPE Support Center: <http://www.hpe.com/support/hpesc>

Industry Standard Compliance

- PXE Support
 - PCIe 3.0 Compliant
 - WOL Support
 - Microsoft® Logo certifications
 - USB 2.0 and 3.0 Support
 - ACPI 2.0 Compliant
-



Standard Features

HPE Server UEFI ROM

Unified Extensible Firmware Interface (UEFI) is an industry standard that provides better manageability and more secured configuration than the legacy ROM while interacting with your server at boot time. The HPE ProLiant e910t Server Blades default to UEFI and does not support Legacy BIOS Boot Mode.

Notes: The UEFI System Utilities function is analogous to the HPE ROM-Based Setup Utility (RBSU) of legacy BIOS. For more information, please visit <http://www.hpe.com/servers/uefi>

UEFI enables numerous new capabilities specific to HPE ProLiant servers such as:

- Secure Boot
- Operating system specific functionality
- Support for > 2.2 TB (using GPT) boot drives
- USB 3.0 Stack
- Embedded UEFI Shell
- Mass Configuration Deployment Tool using RESTful API for iLO 5
- PXE boot support for IPv6 networks
- Boot support for option cards that only support a UEFI option ROM
- Network Stack configurations

Notes: For UEFI Boot Mode, boot environment and OS image installations should be configured properly to support UEFI.

Form Factor

HPE ProLiant e910t Server Blades plug into the HPE Edgeline EL8000t System.

Embedded Management

HPE Integrated Lights-Out Advanced (HPE iLO Advanced)

The ProLiant e910 Server Blades come with iLO Advanced features. For more detail on these features:

<https://psnow.ext.hpe.com/doc/PSN332279USEN.pdf>

Monitor your servers for ongoing management, service alerting, reporting and remote management with HPE iLO.

Learn more at <http://www.hpe.com/info/ilo>

UEFI

Configure and boot your servers securely with industry standard Unified Extensible Firmware Interface (UEFI).

Learn more at <http://www.hpe.com/servers/uefi>.

RESTful API

RESTful API for iLO 5 is Redfish 1.0 conformance for simplified server management such as configuration and maintenance tasks based on modern industry standards.

Learn more at <http://www.hpe.com/info/restfulapi>

Notes: Full REST API is available when the server is installed in a HPE Edgeline System

Intelligent Provisioning

Hassle free server and OS provisioning for 1 or few servers with Intelligent Provisioning.

Learn more at <http://www.hpe.com/servers/intelligentprovisioning>



Standard Features

Server Utilities

Edgeline Component Pack

The HPE Edgeline Component Pack, is the delivery mechanism for firmware updates on the HPE Edgeline System. Before using your system for the first time, verify that you have the latest drivers, firmware, and system software installed.

For more information, see the Edgeline Component Pack Update Guide on the Hewlett Packard Enterprise website:

<http://www.hpe.com/info/edgeline-docs>

Notes: The Edgeline Component Pack is only supported when the server is installed in a HPE Edgeline System

Scripting Tool Kit and Windows PowerShell

Provision 1 to many servers using your own scripts to discover and deploy them with Scripting Tool Kit (STK) for Windows and Linux or Scripting Tools for Windows PowerShell. Learn more at <http://www.hpe.com/servers/proliant/stk>

Or <http://www.hpe.com/servers/powershell>.

Notes: This Feature will be available when the server is installed in a HPE Edgeline System.

RESTful

Interface Tool

RESTful Interface tool is a scripting tool to provision using RESTful API for iLO5 to discover and deploy servers at scale.

Learn more at <http://www.hpe.com/info/resttool>

Notes: This Feature will be available when the server is installed in a HPE Edgeline System.

Security

- Serial interface control
- Administrator's password
- Power-on password
- TPM2.0
- UEFI
- iLO 5 has 12 customizable user accounts and SSL encryption
- iLO 5 can be disabled via a Global Setting
- iLO Advanced supports directory services integration

HPE Trusted Platform Module

HPE Trusted Platform Module 2.0 is embedded on the Server Blade and can be enabled and disabled using the BIOS.

Notes:

- The TPM (Trusted Platform Module) is a microcontroller chip that can securely store artifacts used to authenticate the server platform. These artifacts can include passwords, certificates and encryption keys. Windows® BitLocker™ Drive Encryption (BitLocker) is a data protection feature available in Windows Server® 2008, 2012/2012 R2. BitLocker leverages the enhanced security capabilities of a Trusted Platform Module (TPM) version 2.0. The TPM works with BitLocker to help protect user data and to ensure that a server running Windows Server has not been tampered with while the system was offline. For more information about TPM, including a white paper, go to: <https://www.hpe.com/h20195/v2/gethtml.aspx?docname=c04939549>
 - ProLiant OS pre-installed units will come with the partition required for TPM deployment.
 - The TPM key is unique to every TPM deployed server and must be retained. Misplacing or losing the key could result in data loss.
-



Service and Support

Achieve maximum return from your IT investment

Get the expertise you need at every step of your IT journey with **HPE Pointnext services and support**. We help you lower your risks and costs using proven best practices, automation and methodologies that have been tested and refined by Hewlett Packard Enterprise experts through thousands of deployments globally. With **Advisory Services**, we focus on your business outcomes and goals, partnering with you to design your transformation and build a roadmap tuned to your unique challenges. Our **Professional** and **Operational Services** can be leveraged to speed up time-to-production, boost performance and accelerate your business. HPE Pointnext specializes in flawless and on-time implementation, on-budget execution, and creative configurations that get the most out of software and hardware alike.

Consume IT on your terms

HPE GreenLake Flex Capacity combines the simplicity, agility, and economics of public cloud with the security and performance benefits of on-premises IT. You determine your own “Right Mix” of Hybrid IT and workload placement without having to use.

With its agile pay-per-use service, HPE GreenLake Flex Capacity can help your IT organization:

- Avoid IT expenses stemming from overprovisioning
 - Improve time to market by maintaining a safe buffer of capacity, ready for use when you need it
 - Keep capacity ahead of demand with regular monitoring—and a simple change order to replenish
 - Pay for only the capacity used, not the capacity deployed
 - Reduce IT risk with tailored support
-

Connect your devices

Unlock all of the benefits of your technology investment by connecting your products to Hewlett Packard Enterprise. Reduce down time, increase diagnostic accuracy and have a single consolidated view of your environment. By connecting, you will receive 24x7 monitoring, pre-failure alerts, automatic call logging, and automatic parts dispatch. HPE Proactive Care Service and HPE Datacenter Care Service customers will also benefit from proactive activities to help prevent issues and increase optimization. All of these benefits are already available to you with your server storage and networking products, securely connected to HPE support. Learn more about getting connected at <http://www.hpe.com/services/getconnected>

Free up resources with Operational Services from HPE Pointnext

Choose from the recommended services for customers purchasing from Hewlett Packard Enterprise or an authorized reseller are quoted using Hewlett Packard Enterprise order configuration tools.

HPE Datacenter Care

Helps customers to address the pressing needs of IT today and smoothly transform to a more agile cloud-like IT operations model. We help run and monitor your IT by offloading the day to day routine tasks, helping customers be more predictive and proactive, and saving time with one place to call with for all of their IT. Datacenter Care is available as both tailored statement of work and as a packaged service for 3, 4, and 5 year terms.

Partner with an assigned account team backed by local and global experts, access HPE enhanced call experience with priority access, use specialized support for complex, technologies, choose hardware and software support for your devices, implement proactive monitoring to stay ahead of issues, and access HPE IT best practices and IP. HPE Datacenter Care advantage options are available to add to your agreement to give you specialized expertise for performance, security, back up analysis, and much more.



Service and Support

HPE Proactive Care

Gives customers an enhanced call experience. When your products are connected to HPE, Proactive Care helps prevent problems and maintains IT stability by utilizing personalized proactive reports with recommendations and advice.

HPE Proactive Care is available in 3, 4 and 5 year terms with a choice of response levels: Next Business day (NBD), 24x7 with a 4 hour response, and 24x7 with 6 hour call to repair (CTR). This Service combines both reactive support when there is a problem with an enhanced call experience and start to finish case management with proactive reporting and advice. This service also includes collaborative software support for Independent Software Vendors (ISVs), (Red Hat, VMWare, Microsoft, etc.).

<https://www.hpe.com/h20195/v2/GetPDF.aspx/4AA3-8855ENW.pdf>

HPE Proactive Care Advanced

Incorporates all the deliverables of HPE Proactive Care plus includes personalized support from a local, assigned Account Support Manager who will share best practice advice and personalized recommendations designed to help improve availability and performance to help increase stability and reduce unplanned downtime. Leverage your system's ability to connect to HPE for pre-failure alerts, automatic call logging and parts dispatch. For business critical incidents, Proactive Care Advanced offers critical event management to help reduce mean time to resolution. HPE Service Credits are included to redeem for technical and operational services. HPE Proactive Care Advanced is offered in 3, 4, and 5 year terms with a choice of response levels: Next Business day (NBD), 24x7 with a 4 hour response, and 24x7 with 6 hour call to repair (CTR).

<https://www.hpe.com/h20195/v2/getdocument.aspx?docname=4AA5-3259ENW>

HPE Foundation Care

Notes: Choose the response level that meets your needs)

HPE Foundation Care helps when there is a problem and is available in 3, 4, and 5 year terms with a choice of response levels: Next Business day (NBD), 24x7 with a 4 hour response, and 24x7 with 6 hour call to repair (CTR). Note that Call-To-Repair Service connects you to HPE 24 hours a day, seven days a week for assistance on resolving issues -this includes our highest level commitment to repair hardware within six hours after opening your case and respond to software questions within two hours. In addition, Collaborative software support is included and provides troubleshooting assistance on industry leading software running on your server. Simplify your support experience and make HPE your first call to help resolve hardware or software problems.

<https://www.hpe.com/h20195/V2/GetDocument.aspx?docname=4AA4-8876ENW&cc=us&lc=en>

Other related services from HPE Pointnext

Parts and Materials

Hewlett Packard Enterprise will provide HPE-supported replacement parts and materials necessary to maintain the covered hardware product in operating condition, including parts and materials for available and recommended engineering improvements.

Parts and components that have reached their maximum supported lifetime and/or the maximum usage limitations as set forth in the manufacturer's operating manual, product quick-specs, or the technical product data sheet will not be provided, repaired, or replaced as part of these services.

Defective Media Retention is an option available with HPE Datacenter Care, HPE Proactive Care, Proactive Care Advanced, and HPE Foundation Care and applies only to Disk or eligible SSD/Flash Drives replaced by Hewlett Packard Enterprise due to malfunction.

HPE Server Hardware Installation

Provides for the basic hardware installation of your new Edgeline System. It is part of a suite of HPE deployment services that are designed to give you the peace of mind that comes from knowing your HPE products have been installed by Hewlett Packard Enterprise authorized service specialist in accordance with the product's documentation.

<https://www.hpe.com/h20195/v2/Getdocument.aspx?docname=a00062322enw>

HPE Installation and Startup Service

Provides for the installation of your new Edgeline System. This service will assist you in bringing your new HPE Edgeline System into operation and make it remotely accessible in a timely and professional manner. The HPE service delivery technician will connect the product to the network as appropriate and enable remote support to allow for automatic case creation for hardware



Service and Support

failures. Installation and start up services also includes the installation of one supported operating system type (Windows® or Linux). <https://www.hpe.com/h20195/v2/Getdocument.aspx?docname=a00062211enw>

HPE Service Credits

Offers flexible services and technical skills to meet your IT demands as your business evolves. With a menu of services, you can access additional resources and specialist skills to help you maintain peak performance of your IT. HPE Service Credits help you proactively respond to your dynamic IT and business needs.

HPE Education Services

Provides comprehensive training designed to expand the skills of your IT staff and keep them up to speed with the latest technologies.

Consult your HPE Sales Representative or Authorized Channel Partner of choice for any additional questions and support options.

Warranty

This product is covered by a global limited warranty and supported by Hewlett Packard Enterprise Services and a worldwide network of HPE Authorized Channel Partners resellers. Hardware diagnostic support and repair is available for three years from date of purchase. Support for software and initial setup is available for 90 days from date of purchase. Enhancements to warranty services are available through HPE Pointnext operational services or customized service agreements. Hard drives have either a one year or three year warranty; refer to the specific hard drive QuickSpecs for details.

Notes: Server Warranty includes 3-Year Parts, 3-Year Labor, 3-Year Onsite support with next business day response. Warranty repairs may be accomplished through the use of Customer Self Repair (CSR) parts. These parts fall into two categories: 1) Optional CSR parts are designed for easy replacement but may involve added complexity. Customers may choose to have Hewlett Packard Enterprise replace Optional CSR parts at no charge. 2) No CSR parts are also designed for requiring a Hewlett Packard Enterprise authorized service provider replace the part. Additional information regarding worldwide limited warranty and technical support is available at: <http://h20564.www2.hpe.com/hpsc/wc/public/home>



Configuration Information

Notes:

- This section lists some of the steps required to configure a Factory Integrated Model. To ensure only valid configurations are ordered, Hewlett Packard Enterprise recommends the use of a Hewlett Packard Enterprise approved configurator. Contact your local sales representative for information on configurable product offerings and requirements
- If you want to configure a server blade only, proceed to Step 2

Step 1: Base Configuration (Choose System)

HPE Edgeline System

HPE Edgeline EL8000t 2U Configure-to-order Front Cabling Chassis

P27063-B21

Notes: Refer to the Edgeline EL8000t documentation for details on how to configure the chassis

<https://h20195.www2.hpe.com/v2/getdocument.aspx?docname=a00067727enw>

- Functional systems require at least 1 power supply to be configured, with 2 power supplies recommended for redundancy

Step 2: Select ProLiant Server Blade

HPE ProLiant Server Blade (Min:1, Max:2)

HPE ProLiant e910t 2U Node Configure-to-order Blade Server

P27064-B21

Notes:

- Each blade operates independently
- An iLO Advanced license with 3 years of support is provided by default with each e910t blade (1 per blade)

Step 3: Choose Required Options (per blade)

Processor Option (Min: 1, Max: 1)

Intel Xeon-Platinum 8280M (2.7GHz/28-core/205W) Processor Kit for HPE ProLiant e910

P12398-B21

Intel Xeon-Gold 6254 (3.1GHz/18-core/200W) FIO Processor Kit for HPE ProLiant e910.

P12397-B21

Intel Xeon-Gold 6244 (3.6GHz/8-core/150W) FIO Processor Kit for HPE ProLiant e910.

P12396-B21

Intel Xeon-Gold 6230N (2.3GHz/20-core/125W) FIO Processor Kit for HPE ProLiant e910

P17292-B21

Intel Xeon-Gold 6212U (2.4GHz/24-core/165W) Processor Kit for HPE ProLiant e910

P12395-B21

Intel Xeon-Silver 4210 (2.2GHz/10-core/85W) FIO Processor Kit for HPE ProLiant e910.

P12399-B21

Notes:

- The ProLiant e910t 2U server is only available as a single-socket system (1 processor per blade).
- The Intel Xeon 8280M processor is required to use the full memory capacity (1.5TB) of the ProLiant e910t

Memory Options (Min: 1, Max: 12)

HPE Edgeline 8GB (1x8GB) Single Rank x8 DDR4-2933 CAS-21-21-21 Registered Memory Kit

P12400-B21

HPE Edgeline 16GB (1x16GB) Dual Rank x4 DDR4-2933 CAS-21-21-21 Registered Memory Kit

P12401-B21

HPE Edgeline 32GB (1x32GB) Dual Rank x4 DDR4-2933 CAS-21-21-21 Registered Memory Kit

P12402-B21

HPE Edgeline 64GB (1x64GB) Quad Rank x4 DDR4-2933 CAS-21-21-21 Load Reduced Memory Kit

P12403-B21

HPE Edgeline 128GB (1x128GB) Octal Rank x4 DDR4-2933 CAS-21-21-21 Load Reduced Memory Kit

P12404-B21

Notes:

- Mixing of RDIMMs and LRDIMMs within the same blade is not supported
- Mixing of different LRDIMM capacity kits is not supported (i.e. 64GB & 128GB)
- Ensure that the selected processor supports the configured memory footprint of the blade e.g. Intel Xeon



Configuration Information

8280M is required to use the maximum 1.5TB capacity (Twelve 128 GB LRDIMMs).

Riser options

Left Riser Options (Min: 1, Max: 1)

Notes: The Left Riser option is required on each server blade

HPE e910t x16 FHFL+ x16 HHHL Riser Kit P22496-B21

Notes: This option (P22496-B21) supports One (1) PCIe Gen3 FHFL x16 card and One (1) PCIe Gen3 HHHL x8 card

HPE e910t 2x16 FHFL+ x16 HHHL Riser Kit P27066-B21

Notes: This option (P27066-B21) supports Two (2) PCIe Gen3 FHFL x8 cards and One (1) PCIe Gen3 HHHL x8 card.

Right Riser Options (Min: 0, Max: 1)

HPE ProLiant e910 4-slot NVMe M.2 Enablement Kit P12386-B21

Notes: The M.2 Enablement Kit (P12386-B21) supports four (4) M.2 NVMe SSD slots, which can fit 2280 or 22110 sizes. There are no PCIe I/O add-in card slots available with this riser option.

Solid State Drives

Installed on e910t System Board (Min: 1, Max: 2)

Notes: The system board has two (2) M.2 slots which can accept SATA or NVMe SSDs limited to 2242 or 2280 sizes. These slots do not support 22110 size SSDs.

HPE 120GB SATA M.2 2242 Solid State Drive Field Upgradable Kit 866842-B21

HPE 240GB SATA M.2 2242 Solid State Drive Field Upgradable Kit 866844-B21

HPE 256GB NVMe x4 Lanes Read Intensive M.2 2280 1yr Wty Extended Temperature SSD 880262-B21

HPE 512GB NVMe x4 Lanes Read Intensive M.2 2280 1yr Wty Extended Temperature SSD 880264-B21

HPE 1TB NVMe x4 Lanes Read Intensive M.2 2280 1yr Wty Extended Temperature SSD 880266-B21

HPE Edgeline 2TB NVMe x4 Lanes Read Intensive M.2 2280 1yr Wty Extended Temperature SSD P00375-B21

Installed on Right Riser (Min: 0, Max: 4)

HPE 256GB NVMe x4 Lanes Read Intensive M.2 2280 1yr Wty Extended Temperature SSD 880262-B21

HPE 512GB NVMe x4 Lanes Read Intensive M.2 2280 1yr Wty Extended Temperature SSD 880264-B21

HPE 1TB NVMe x4 Lanes Read Intensive M.2 2280 1yr Wty Extended Temperature SSD 880266-B21

HPE Edgeline 2TB NVMe x4 Lanes Read Intensive M.2 2280 1yr Wty Extended Temperature SSD P00375-B21

HPE Edgeline 960GB NVMe x4 Lanes Mixed Use M.2 22110 3yr Wty Extended Temperature SSD P05892-B21

HPE Edgeline 1.92TB NVMe x4 Lanes Mixed Use M.2 22110 3yr Wty Extended Temperature SSD P05896-B21

HPE Edgeline 3.84TB NVMe x4 Lanes Mixed Use M.2 22110 3yr Wty Extended Temperature SSD P05900-B21

Notes: The P12386-B21: HPE e910 4 Slot NVMe M.2 Enablement Kit provides 4 M.2 slots that can fit 2280 and 22110 SSDs. Only NVMe SSDs are supported.



Configuration Information

Network Riser Kits (Min: 1, Max: 1)

Notes: The network riser connects the embedded Intel X722 quad-port 10GbE NIC on each e910t blade to the blade faceplate

HPE ProLiant e910 4x10GbE QSFP+ Module P12392-B21

Notes: All 4 10GbE ports are presented on the faceplate of the respective blade.

HPE ProLiant e910 2-port 1GbE RJ45 Module P17295-B21

HPE ProLiant e910 2-port 10GbE SFP+ Module P17296-B21

Notes: The RJ45 and SFP+ network riser modules connect 2 10GbE ports to the blade faceplate. The remaining 2 ports from the embedded NIC are unused.



Additional Options

Step 4: Choose Additional Options

Choose additional options for Factory Integration from sections below

PCIe Slot Options:

Notes: Ensure that the riser type configured in the e910t blade can fit the selected PCIe add-in card option

Networking

HPE Eth 10/25Gb 2p 661SFP28 Adptr 870825-B21

Accelerators and associated accessories

HPE NVIDIA Tesla T4 16GB Computational Accelerator ROW29A

Pensando DSP DSC-25 10/25G 2p SFP28 Card P26966-B21

Notes: If the Pensando DSP DSC-25 (P26966-B21) is selected, an accompanying RTU license must be ordered.

Supported Cables

Notes: Optional cables for connection to either the QSFP+/SFP+/RJ45 network riser ports on the blade faceplate

HPE FlexNetwork X240 40G QSFP+ QSFP+ 1m Direct Attach Copper Cable	JG326A
HPE FlexNetwork X240 40G QSFP+ QSFP+ 3m Direct Attach Copper Cable	JG327A
HPE FlexNetwork X240 40G QSFP+ QSFP+ 5m Direct Attach Copper Cable	JG328A
HPE FlexNetwork X240 40G QSFP+ to 4x10G SFP+ 1m Direct Attach Copper Splitter Cable	JG329A
HPE FlexNetwork X240 40G QSFP+ to 4x10G SFP+ 3m Direct Attach Copper Splitter Cable	JG330A
HPE FlexNetwork X240 40G QSFP+ to 4x10G SFP+ 5m Direct Attach Copper Splitter Cable	JG331A
HPE BladeSystem c-Class 10Gb SFP+ SR Transceiver	455883-B21
Aruba 1G SFP RJ45 T 100m Cat5e Transceiver	J8177D
HPE FlexNetwork X240 10G SFP+ to SFP+ 1.2m Direct Attach Copper Cable	JD096C
HPE BladeSystem c-Class 10GbE SFP+ to SFP+ 3m Direct Attach Copper Cable	487655-B21
HPE EL DC Power 10 feet CBL Kit 1	P27698-B2
HPE FlexNetwork X240 40G QSFP+ to 4x10G SFP+ 3m DAC Cable 1	JG330,
HPE 100Gb QSFP28 to QSFP28 3m DAC Cable 1	845406-B2



Technical Specifications

HPE Edgeline e910t Server Blade

Physical Dimensions

Server Cartridge

- **Dimensions (H x W x D):** 3.2 x 8.4 x 14.4in (8.13 x 21.34x 36.58cm)
- **Typical Power:** 300W per U
- **Max Power:** 400W per U

System Inlet Temperature

- **Extended Operating**
HPE Edgeline EL8000t with ProLiant e910t Server Blades: Depending on hardware configuration, the supported system inlet range can be extended up to 55°C. Compliance to ASHRAE A3 and A4 standards is also available. The approved hardware configurations for this system are listed in the Edgeline system documentation.
- **Standard Operating**
HPE Edgeline EL8000t Chassis with ProLiant e910t Server Blades: Typical range is 10° to 35°C (50° to 95°F) with altitude derating.

Emissions Classification (EMC)

- **FCC Rating:** Class A
- **Normative Standards**
 - CISPR 22;
 - EN55022;
 - EN55024;
 - FCC CFR 47, Pt 15;
 - ICES-003;
 - CNS13438;
 - K22;K24;
 - EN 61000-3-2;
 - EN 61000-3-3;
 - EN 60950-1;
 - IEC 60950-1

Notes: Product conformance to cited product specifications is based on sample (type) testing, evaluation, or assessment. This product or family of products is eligible to bear the appropriate compliance logos and statements.

Environment-friendly Products and Approach - End-of-life Management and Recycling

Hewlett Packard Enterprise offers end-of-life **product return, trade-in, and recycling programs**, in many geographic areas, for our products. Products returned to Hewlett Packard Enterprise will be recycled, recovered or disposed of in a responsible manner.

The EU WEEE Directive (2012/19/EU) requires manufacturers to provide treatment information for each product type for use by treatment facilities. This information (product disassembly instructions) is posted on the **[Hewlett Packard Enterprise web site](#)**. These instructions may be used by recyclers and other WEEE treatment facilities as well as Hewlett Packard Enterprise OEM customers who integrate and re-sell Hewlett Packard Enterprise equipment.



Summary of Changes

Date	Version History	Action	Description of Change
01-Jun-2020	Version 1	New	New QuickSpecs



Copyright

Make the right purchase decision.
Contact our presales specialists.



Chat



Email



Call

Hewlett Packard Enterprise



Get updates



Hewlett Packard
Enterprise

© Copyright 2020 Hewlett Packard Enterprise Development LP. The information contained herein is subject to change without notice. The only warranties for Hewlett Packard Enterprise products and services are set forth in the express warranty statements accompanying such products and services. Nothing herein should be construed as constituting an additional warranty. Hewlett Packard Enterprise shall not be liable for technical or editorial errors or omissions contained herein.

a00073756enw - 16609 - WorldWide - V1 - 01-June-2020